

General Information	2
Guarantee	2
Regular Maintenance and Service	2
Information on Disposal	2
Technical Modifications	2
CE Mark	2
Safety Instructions	2
Door/Window Contact	4
Intended Use	5
Installation	6
Technical Data	7
Glass Breakage Detector	8
Intended Use	8
Installation	9
Technical Data	10

Contents

Water Leak Detector	11
Intended Use	12
Installation	13
Technical Data	14
Wireless Motion Detector	15
Intended Use	15
Installation	16
Technical Data	17
Smoke Detector RTX	18
Intended Use	19
Installation	20
Technical Data	22
Remote Control	23
Intended Use	23
Starting Up	24
Technical Data	25

SOS Remote Control	26
Intended Use	26
Starting Up	27
Technical Data	27
Convenient Remote Control	28
Intended Use	29
Starting Up	29
Technical Data	31
Outdoor Siren	32
Intended Use	32
Installation	33
Technical Data	33
GSM Antenna	34
Intended Use	34
Installation	35
Technical Data	35

General Information

Guarantee

The period of guarantee is 24 months. The period of guarantee begins on the date of purchase.

In the case of problems, please contact our hotline:

0180 5 007514 (costs using a German landline at time of going to print:
14 ct/min., max. 42 ct/min. using a mobile network.)

If the problem cannot be solved per telephone, you can send your device, packed in the original packaging with the purchase receipt enclosed, to the following address:

Service Center Hattingen
Zum Kraftwerk 1
45527 Hattingen

Regular Maintenance and Service

1. Clean the surface of the housing with a soft, lint-free cloth. Never use any chemicals or scouring agents.
2. Complete a function test once a month and after changing the batteries.
3. Change the batteries once a year.

Information on Disposal



The adjacent symbol indicates that **electrical and electronic apparatus and batteries** no longer required must be disposed of separate from domestic waste in accordance with legal directives.



You are obliged to dispose of **batteries and power packs** at shops which sell batteries or collection points which provide the corresponding containers. Disposal is free of charge. The symbols indicate that the batteries must not be disposed of in normal domestic waste and that they must be brought to collection points provided by local public waste authorities.

Packaging materials must be disposed of according to local regulations.

Technical Modifications

This instruction manual serves purely for information purposes. Its content is not part of any contract for sale. All the data relates to nominal values. The equipment and options described may differ from country to country according to national requirements.

CE Mark



The devices fulfil the requirements stipulated in the EU Directive 1999/5/EC (R&TTE).

The CE Mark on the devices confirms conformity.

Safety Instructions

The following safety instructions are valid for the entire document. Read the safety instructions and observe the information contained to protect both yourself and the environment.

WARNING:

- Risk of suffocation!

Children could swallow small parts, packing materials or protective foil.

➔ Keep the product and packaging out of reach of children!

CAUTION!

- Risks to health and the environment from batteries!

Improper handling of batteries can put your health and the environment at risk.

➔ Never open, damage or swallow batteries or allow them to pollute the environment. Batteries may contain toxic, ecologically hazardous heavy metals.

- Hearing damage through loud alarm signal!

The alarm signal is loud and could cause hearing damage.

➔ Only use the product in the recommended installation locations.

➔ Do not hold the product near your ears to test it.

➔ Do not remain in the vicinity of the acoustic alarm for a longer period when it has been triggered.

ATTENTION!

- Property damage through environmental influences!

Harmful environmental influences such as exposure to smoke, dust, vibration, chemicals, moisture, heat and direct sunlight, could damage the product.

➔ Prevent environmental influences such as exposure to smoke, dust, vibration, chemicals, moisture, heat and direct sunlight.

Door/Window Contact

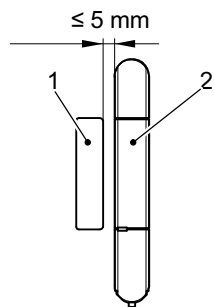

Fig. 1

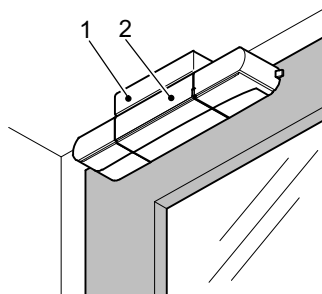

Fig. 2

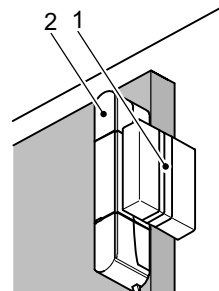

Fig. 3

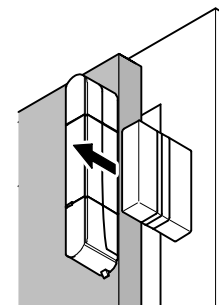

Fig. 4

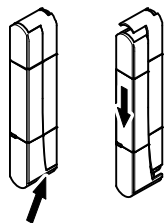

Fig. 5

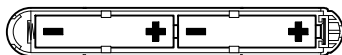

Fig. 6

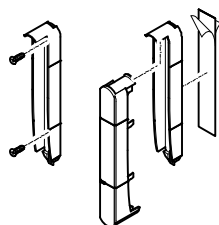

Fig. 7

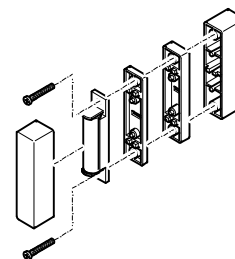

Fig. 8

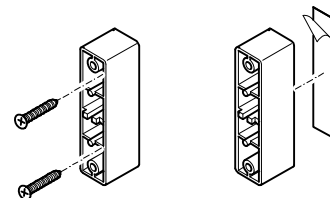



Fig. 9

Intended Use

The door/window contact serves to monitor the position of doors and windows. It is designed for use together with an alarm system from the Protect series.

A condition for complying with the intended use is that the equipment is installed correctly and the information in this instruction manual is observed and maintained.

Any other use is considered unintended use. Unauthorised modification or reconstruction not described in this instruction manual is not permitted and could lead to product damage. Furthermore, risks through short-circuits, fire, electric shock etc. cannot be ruled out.

 The door/window contact only works in combination with an alarm system from the Protect series!

Important Safety Information

WARNING:

- Risk of suffocation!

Children could swallow small parts, packing materials or protective foil.

➡ **Keep the product and packaging out of reach of children!**

Scope of Delivery

Door/Window contact	1
Batteries	2 AAA batteries
Assembly material	Screws, dowels
Instruction manual	1

Please check the contents of the package carefully. If anything is missing or has been damaged during transport, DO NOT put the door/window contact into operation!

Installation

Recommended Installation Locations

 The installation location must be within transmission range of the base unit of the Protect wireless alarm system.

A door/window contact is comprised of two components: the magnet unit (Fig. 1-1) and the door/window detector (Fig. 1-2).

Example Installation, Window

The door/window detector (Fig. 2-2) is assembled on the window sash and the magnet unit (Fig. 2-1) on the window frame.

Example Installation, Door

The door/window detector (Fig. 3-2) is assembled on the door leaf and the magnet unit (Fig. 3-1) on the door frame.

Installation Steps

WARNING!

- Risk of serious injuries through damaging cables or lines!
- ➡ During installation, pay attention to the possibility of cables running in the walls. We are not deemed liable for installation errors. If in doubt, contact a specialist!

i Only assemble the door/window contact in the position and alignment illustrated in Fig. 4. Otherwise, there is no guarantee that the door/window contact will function properly.

1. Open the door/window detector by pressing the lock downwards in direction of the arrow and sliding the upper section towards the lock. Refer to Fig. 5.
2. The assembly shell of the door/window detector is fixed in place on the door/window by means of double-sided adhesive tape or two screws. Refer to Fig. 7.

i When using double-sided adhesive tape, pay attention that the application surfaces are free of dust and grease.

3. Insert the AAA batteries in the battery compartment (pay attention to correct polarity). Refer to Fig. 6.

4. Slide the upper section of the door/window detector onto the assembly shell until it snaps in place.

5. The magnet unit is comprised of a fixation base, two spacers, a permanent magnet and a cap. Dismantle the unit into its individual parts by pulling it apart. Refer to Fig. 8.

6. The fixation base is secured in place by means of double-sided adhesive tape or two screws. Pay attention to the maximum distance of 5 mm to the door/window detector. Refer to Fig. 1.

i When using double-sided adhesive tape, pay attention that the application surfaces are free of dust and grease.

7. Screw the permanent magnet firmly to the fixation base. Check the height in relation to the door/window detector beforehand and use the optionally available spacers which can be plugged onto the fixation base. Refer to Fig. 8.

8. Place the cap on the permanent magnet.

Registering the Door/Window Contact on the Alarm System

The door/window contact must be registered on an alarm system from the Protect series. This can also be used to activate further alarm systems and send alarm signals via the telephone network.

1. Select the **Register** menu option on the alarm system.
2. Trigger the sensor by opening the window, for example.
3. When the message **Magn. Sens.** followed by a number appears in the alarm system display, registration on the alarm system was successful.
4. Change the entry in the alarm system as necessary.

i To configure the alarm system, please refer to the manual related to the alarm system.

Technical Data

Weight:	38 g
Dimensions (W x H x D):	Door/Window detector 15.7 x 106.8 x 22 mm Magnet unit 11.5 x 48 x 34.5 mm
Frequency:	868 MHz
Batteries	2 x AAA batteries

Glass Breakage Detector

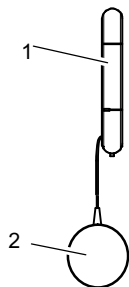

Fig. 1

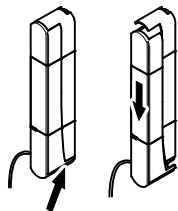

Fig. 2



Fig. 3

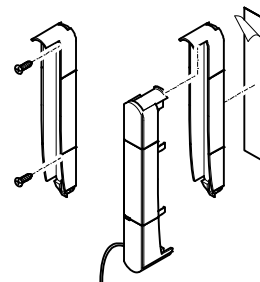

Fig. 4

Intended Use

The glass breakage detector reacts to vibration, which is a typical result of an attempted burglary (smashing, drilling, sawing, levering), and sends a radio signal which can be received by alarm systems in the Protect series. This glass breakage detector can be used to monitor windows and doors.

A condition for complying with the intended use is that the equipment is installed correctly and the information in this instruction manual is observed and maintained.

Any other use is considered unintended use. Unauthorised modifications or reconstructions not described in this instruction manual are not permitted and could cause the product to be damaged. Furthermore, risks through short-circuits, fire, electric shock etc. cannot be ruled out.

i The glass breakage detector only works in combination with an alarm system from the Protect series.

Important Safety Information

WARNING:

• Risk of suffocation!

Children could swallow small parts, packing materials or protective foil.

➔ Keep the product and packaging out of reach of children!

Glass breakage detector	1
Batteries	2 x AAA batteries
Assembly material	Screws, dowels
Instruction manual	1

Please check the contents of the package carefully. If anything is missing or has been damaged during transport, DO NOT put the glass breakage detector into operation!

Installation

Recommended Installation Locations

 The installation location must be within transmission range of the base unit of the Protect series alarm system.

The glass breakage detector should be installed

- on objects which are valuable or contain valuable items, e.g. pictures, safes, drawers etc.,
- on objects which can be easily broken or forced open, e.g. glass panes, plasterboard walls, wooden doors, etc.

Inappropriate Installation Locations

The glass breakage detector must **not** be installed

- near the floor,
- in the vicinity of metallic structures, electrical lines or gas pipelines, electrical or radio equipment,
- on objects which move of their own accord.

Installation Steps

WARNING!

- Risk of serious injuries through damaging cables or lines!
- ➔ During installation, pay attention to the possibility of cables running in the walls. We are not deemed liable for installation errors. If in doubt, contact a specialist!

1. Open the glass breakage detector (Fig . 1-1) by pressing the lock downwards in direction of the arrow and sliding the upper section towards the lock. Refer to Fig . 2.
2. The assembly shell of the glass breakage detector is fixed in place by means of double-sided adhesive tape or two screws. (You can use the assembly shell as a template for positioning the drill holes.) Refer to Fig . 4.

Glass Breakage Detector

- i** When using double-sided adhesive tape, pay attention that the application surfaces are free of dust and grease.
- 3. Slide the upper section of the glass breakage detector onto the assembly shell until it snaps in place.
- 4. Adhere the sensor (Fig. 1-2) to the object to be monitored.

Inserting the Batteries

1. Open the glass breakage detector (Fig. 1-1) by pressing the lock downwards in direction of the arrow and sliding the upper section towards the lock. Refer to Fig. 2.
2. Insert the AAA batteries in the battery compartment (pay attention to correct polarity!). Refer to Fig. 3.
3. Slide the upper section of the glass breakage detector onto the assembly shell until it snaps in place.

Registering the Glass Breakage Detector on the Alarm System

The glass breakage detector must be registered on an alarm system from the Protect series. This can also be used to activate further alarm systems and send alarm signals via the telephone network.

1. Select the **Register** menu option on the alarm system.
2. Remove a battery from the glass breakage detector and then replace it in the glass breakage detector.
3. When the message **Shock Sens.** followed by a number appears in the alarm system display, registration on the alarm system was successful.
4. Change the entry in the alarm system as necessary.

- i** To configure the alarm system, please refer to the manual related to the alarm system.

Technical Data

Weight:	26 g
Dimensions (W x H x D):	15 x 105 x 22 mm
Frequency:	868.5 MHz
Battery	2 x AAA batteries

Water Leak Detector



Fig. 1

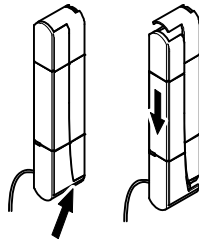

Fig. 2



Fig. 3

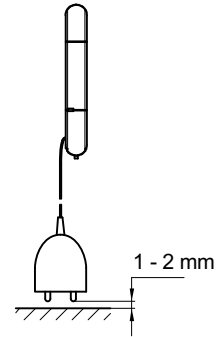

Fig. 4

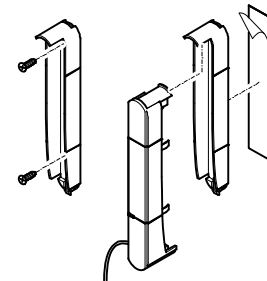



Fig. 5

Intended Use

The water leak detector serves to prevent or minimise water damage by providing an early warning when a water level is exceeded. It is designed for operation in combination with an alarm system from the Protect series and exclusively intended as a home water leak detector for private purposes, indoors.

A condition for complying with the intended use is that the equipment is installed correctly and the information in this instruction manual is observed and maintained.

Any other use is considered unintended use. Unauthorised modifications or reconstructions not described in this instruction manual are not permitted and could cause the product to be damaged. Furthermore, risks through short-circuits, fire, electric shock etc. cannot be ruled out.

 The water leak detector only works in combination with an alarm system from the Protect series.

Important Safety Information



- Risk of suffocation!

Children could swallow small parts, packing materials or protective foil.

➡ Keep the product and packaging out of reach of children!

Notes on Use

 The water leak detector detects moisture and liquids on the floor by means of contacts integrated in the housing. When the water leak detector is tripped, it sends a radio signal which can be received by alarm systems from the Protect series.

Scope of Delivery

Water leak detector	1
Batteries	2 x AAA batteries
Assembly material	Screws, dowels
Instruction manual	1

Please check the contents of the package carefully. If anything is missing or has been damaged during transport, DO NOT put the water leak detector into operation!

Installation

Recommended Installation Locations

i The installation location must be within transmission range of the base unit of the Protect series alarm system.

- Rooms in which there is a risk of flooding due to equipment which uses or supplies water (e.g. washing machine), taps (e.g. connection for garden hose), intrusion of rainwater or facilities which can overflow (e.g. bathtub).
- To prevent overflowing and flooding from equipment containing water, hang the sensors in the container at the height of the required fill level.

Installation Steps



WARNING!

- Risk of serious injuries through damaging cables or lines!
- ➡ During installation, pay attention to the possibility of cables running in the walls. We are not deemed liable for installation errors. If in doubt, contact a specialist!

i The optimum distance between the sensor contacts and floor is 1 - 2 mm. Refer to Fig. 4.

1. Open the water leak detector by pressing the lock downwards in direction of the arrow and sliding the upper section towards the lock. Refer to Fig. 2.
2. The assembly shell of the water leak detector is fixed in place by means of double-sided adhesive tape or two screws. (You can use the assembly shell as a template for positioning the drill holes.) Refer to Fig. 5.

i When using double-sided adhesive tape, pay attention that the application surfaces are free of dust and grease.

3. Slide the upper section of the water leak detector onto the assembly shell until it snaps in place.

Inserting the Batteries

1. Open the water leak detector by pressing the lock downwards in direction of the arrow and sliding the upper section towards the lock. Refer to Fig. 2.
2. Insert the AAA batteries in the battery compartment (pay attention to correct polarity). Refer to Fig. 3.
3. Slide the upper section of the water leak detector onto the assembly shell until it snaps in place.

Registering the Water Leak Detector on the Alarm System

The water leak detector must be registered on an alarm system from the Protect series. This can also be used to activate further alarm systems and send alarm signals via the telephone network.

1. Select the **Register** menu option on the alarm system.
2. Trip the sensor by holding it in a glass of water, for example.
3. When the message **FloodSensor** followed by a number, appears in the alarm system display, registration on the alarm system was successful.
4. Change the entry in the alarm system as necessary.

 To configure the alarm system, please refer to the manual related to the alarm system.

Technical Data

Weight:	34 g
Dimensions (W x H x D):	15 x 105 x 22 mm
Frequency:	868.5 MHz
Batteries	2 x AAA batteries

Wireless Motion Detector

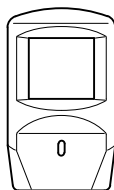

Fig. 1

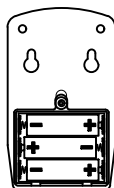

Fig. 2

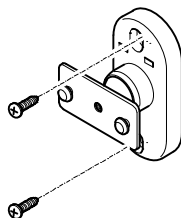

Fig. 3

Intended Use

The wireless motion detector reacts to movements within the area scanned by the sensor and sends a radio signal which can be received by alarm systems from the Protect series.

A condition for complying with the intended use is that the equipment is installed correctly and the information in this instruction manual is observed and maintained.

Any other use is considered unintended use. Unauthorised modifications or reconstructions not described in this instruction manual are not permitted and could cause the product to be damaged. Furthermore, risks through short-circuits, fire, electric shock etc. cannot be ruled out.

i The wireless motion detector only works in combination with an alarm system from the Protect series.

Important Safety Information

⚠ WARNING:

- Risk of suffocation!

Children could swallow small parts, packing materials or protective foil.

➔ Keep the product and packaging out of reach of children!

Scope of Delivery

Wireless motion detector	1
Batteries	3 x AA batteries
Assembly material	Screws, dowels
Wall bracket	1
Instruction manual	1

Please check the contents of the package carefully. If anything is missing or has been damaged during transport, DO NOT put the water leak detector into operation!

Installation

Recommended Installation Locations

- The installation location must be within transmission range of the base unit of the Protect series alarm system.

The installation location of the wireless motion detector must be selected so that an intruder must pass through the area monitored.

An optimal installation location is directly in a corner, between 2 and 3 meters above the floor at an angle of 14 degrees. The possible direction of movement of an intruder should be frontal towards the wireless motion detector.

Inappropriate Installation Locations

The area monitored by the wireless motion detector should not be obstructed by objects (e.g. furniture, curtains, etc.).

Avoid locations in which there is a quick temperature change in the area monitored; near an air-con unit or heater, for example.

- No pets should have access to the area to be monitored by the wireless motion detector when the alarm system is armed.

Wall Installation



WARNING!

- Risk of serious injuries through damaging cables or lines!
- ➔ During installation, pay attention to the possibility of cables running in the walls. We are not deemed liable for installation errors. If in doubt, contact a specialist!

The wireless motion detector is provided with a wall bracket which can be mounted on a wall as well as on a ceiling.

1. Screw the wall bracket to the chosen installation location using two screws approx. 45 mm apart. (It may be necessary to drill the two holes first and then insert dowels in which to tighten the screws, depending on the properties of the wall.) Refer to Fig. 3.
2. Hook the wireless motion detector over the pins on the wall bracket and pull the housing downwards a little.

Inserting the Batteries

1. Use a screwdriver to loosen the screw in the battery compartment cover on the rear side of the wireless motion detector.
2. Remove the battery compartment cover.
3. Insert the AA batteries in the battery compartment (pay attention to correct polarity). Refer to Fig. 2.
4. Replace the battery compartment cover.
5. Replace and tighten the screw.

i The wireless motion detector automatically transmits a signal to the base unit when the battery charge has dropped below a critical level.

Registering the Wireless Motion Detector on the Alarm System

The wireless motion detector must be registered on an alarm system from the Protect series. This can also be used to activate further alarm systems and send alarm signals via the telephone network.

1. Select the **Register** menu option on the alarm system.
2. Move inside the area monitored by the wireless motion detector.
3. When the message **PIR Sensor** followed by a number appears in the alarm system display, registration on the alarm system was successful.
4. Change the entry in the alarm system as necessary.

i To configure the alarm system, please refer to the manual related to the alarm system.

Technical Data

Weight:	88 g
Dimensions (W x H x D):	70 x 127 x 40 mm
Frequency:	868.5 MHz
Batteries	3 x AA batteries
Monitoring radius	120°
Max. monitoring range	8 m

Smoke Detector RTX

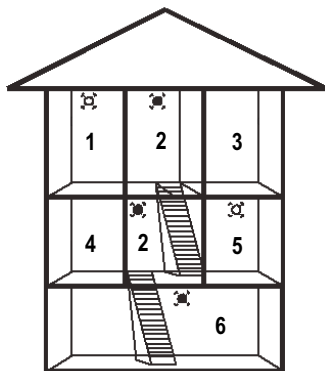
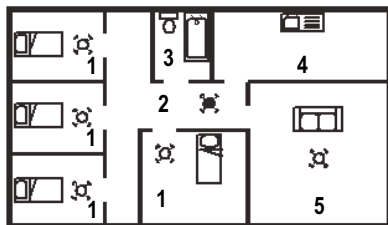

Fig. 1

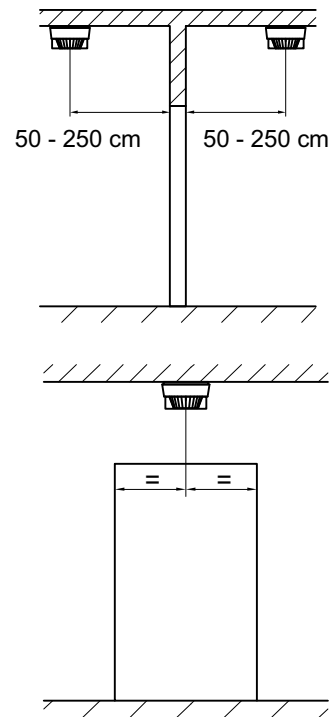

Fig. 2

Fig. 3

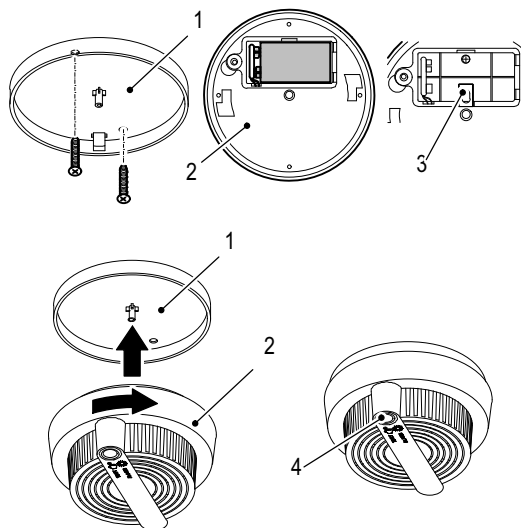

Fig. 4

Intended Use

The RTX smoke detector serves for the detection of smoke indoors and to issue a loud acoustic signal if it is detected. In addition, the RTX smoke detector sends a radio signal which can be received by alarm systems from the Protect series. The RTX smoke detector can also receive an alarm signal from the alarm system and be activated by it in order to signal a smoke alarm.

A condition for complying with the intended use is that the equipment is installed correctly and the information in this instruction manual is observed and maintained.

Any other use is considered unintended use. Unauthorised modifications or reconstructions not described in this instruction manual are not permitted and could cause the product to be damaged. Furthermore, risks through short-circuits, fire, electric shock etc. cannot be ruled out.

Important Safety Information

⚠ WARNING:

- Risk of suffocation!

Children could swallow small parts, packing materials or protective foil.

➔ Keep the product and packaging out of reach of children!

⚠ CAUTION!

- Hearing damage through loud alarm signal!

The alarm signal is loud and could cause hearing damage.

➔ Only use the product in the recommended installation locations.

➔ Do not hold the product near your ears to test it.

Notes on Use

- Smoke detectors only monitor a restricted area! Therefore, install a sufficient number of smoke detectors to ensure optimum protection.
- The smoke detector only works with properly charged, correctly installed batteries. The smoke detector must not be operated using rechargeable batteries.

- The smoke detector must not be painted over.
- The smoke detector detects smoke from a fire, not the flames themselves.
- Smoke detectors do not extinguish fires. Always remain calm and level-headed should the alarm be triggered, initiate appropriate measures and call the fire service, if necessary.
- It should be possible to hear the smoke detector throughout the entire living area.
- People under the influence of alcohol, medication or drugs may not be alerted/ woken by the alarm signal.

Scope of Delivery

Smoke detector RTX	1
Battery	1 x 9 V power pack
Assembly material	Screws, dowels
Instruction manual	1

Please check the contents of the package carefully. If anything is missing or has been damaged during transport, DO NOT put the smoke detector into operation!

Installation

Recommended Installation Locations

It is assumed that a smoke detector can monitor a circular area with a diameter of 4 meters. Therefore, install

- a smoke detector in the hall area (escape route monitoring) between living and sleeping areas,
- a smoke detector in each living room and bedroom,
- at least one smoke detector in the hallway of each floor in the case of multi-storey buildings,
- a smoke detector above the stairs in cases where an attic has been upgraded to a living area. Refer to Fig. 1.

1	Bedroom
2	Hall
5	Living room
6	Cellar

Inappropriate Installation Locations

The smoke detector must not be installed

- in the vicinity of air ducts and areas subject to draughts,
- directly under the roof (min. distance of 30 cm to the roof of an attic),
- in rooms in which vapours, dust or smoke develop under normal conditions (examples of this are workshops, kitchens, bathrooms, laundries, etc.),
- in rooms with temperatures over +40 °C or under +5 °C. Refer to Fig. 1.

3	Bathroom
4	Kitchen

Installation Dimensions and Clearances

- Only install the smoke detector on jointless, smoke-impervious ceilings.
- Install the smoke detector directly underneath the ceiling surface.
- Always install the smoke detector horizontally (even with sloping ceilings).
- The clearance between the smoke detector and a wall containing an opening to be protected must be minimally 50 m and maximally 250 m. Refer to Fig. 2.
- Position the smoke detector centred over the door opening. Refer to Fig. 3.

Installation Steps



WARNING!

- Risk of serious injuries through damaging cables or lines!
- ➡ During installation, pay attention to the possibility of cables running in the walls. We are not deemed liable for installation errors. If in doubt, contact a specialist!

Proceed as follows to install the smoke detector:

1. Ensure that there are no electric cables, gas or water pipes near the installation location.
2. Screw the assembly bracket (Fig. 4-1) to the ceiling at the chosen installation location using two screws approx. 80 mm apart. (It may be necessary to drill the holes first and then insert dowels in which to tighten the screws, depending on the properties of the ceiling.)
3. Connect the 9 V power pack supplied to the battery clip of the smoke detector (Fig. 4-2).
4. Insert the 9 V power pack in the battery compartment of the smoke detector (Fig. 4-2). To do this, slide the latch (Fig. 4-3) in the device. The latch (Fig. 4-3) prevents the smoke detector being installed without a battery.
5. Hook the smoke detector (Fig. 4-2) on the assembly bracket (Fig. 4-1) and turn the smoke detector (Fig. 4-2) in the direction of the arrow until it audibly locks in place.



- Complete a function test following installation! Press the Test button (Fig. 4-4). The acoustic alarm and control lamp functions are tested.

Registering the Smoke Detector on the Alarm System

The RTX smoke detector can be registered on an alarm system from the Protect series. This can also be used to activate further alarm systems and send alarm signals via the telephone network. If the alarm system is triggered by a different smoke detector, this smoke detector is also activated by the alarm system to issue an alarm.

1. Select the **Register** menu option on the alarm system.
2. Press the Test button (Fig. 4-4) on the smoke detector.
3. When the message **SmokeSensor** followed by a number, appears in the alarm system display, registration on the alarm system was successful.
4. Change the entry in the alarm system as necessary.

- To configure the alarm system, please refer to the manual related to the alarm system.

Regular Maintenance and Service

- Accumulations of dust and cobwebs can affect the function of the smoke detector and cause faulty alarms.

1. Clean the surface of the housing with a soft, lint-free cloth. Never use any chemicals or scouring agents.
2. Clean the smoke inlet with a brush.
3. Clean dust and cobwebs as necessary.
4. Complete a function test once a month and after changing the batteries.
5. Change the batteries once a year.

Technical Data

Weight:	120 g
Dimensions (Ø x H):	108 x 53.5 mm
Frequency:	868 MHz
Battery	1 x 9 V power pack

Remote Control

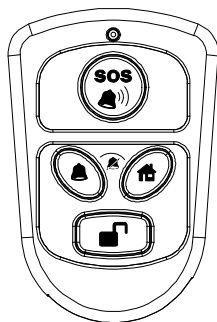

Fig. 1

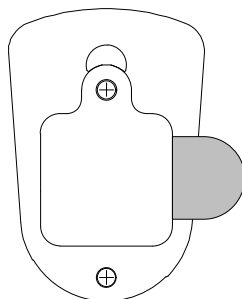

Fig. 2

Intended Use

The remote control serves for the remote control of an alarm system from the Protect series.

A condition for complying with the intended use is that the equipment is installed correctly and the information in this instruction manual is observed and maintained.

Any other use is considered unintended use. Unauthorised modifications or reconstructions not described in this instruction manual are not permitted and could cause the product to be damaged. Furthermore, risks through short-circuits, fire, electric shock etc. cannot be ruled out.

i The remote control only works in combination with an alarm system from the Protect series!

Important Safety Information

⚠ WARNING:

- Risk of suffocation!

Children could swallow small parts, packing materials or protective foil.

➔ Keep the product and packaging out of reach of children!

Scope of Delivery





Remote control	1
Battery	1 x lithium CR2430 3 V
Instruction manual	1

Please check the contents of the package carefully. If anything is missing or has been damaged during transport, DO NOT put the remote control into operation!

Starting Up

The remote control is supplied with a battery already inserted. To put the remote control into operation, remove the plastic strips (Fig. 2) from the battery on the rear side.

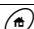
Operating Elements

Key	Function
	Emergency call or panic function (can be optionally configured on the base unit)
	Alarm mode: On burglary, acoustic alarm signal issued and internal telephone dialling unit activated
	At Home mode: On burglary, acoustic alarm is issued
	Disable base unit key lock function, Stop the alarm signal, Disarm the alarm system.
	Silent mode on pressing the Alarm and At Home mode buttons simultaneously

Registering the Remote Control on the Alarm System

The remote control must be registered on an alarm system from the Protect series.

1. Select the **Register** menu option on the alarm system.
2. Press the SOS button  on the remote control.
3. When the message **Remote:** followed by a number appears in the alarm system display, registration on the alarm system was successful.
4. Change the entry in the alarm system as necessary.

i To configure the alarm system, please refer to the manual related to the alarm system.

Configuring the SOS Button

The  button on the remote control can be configured as an Emergency Call (SOS) or Panic button via the Protect alarm system base unit.

i To configure the alarm system, please refer to the manual related to the alarm system.

Stopping the Alarm

i If an outdoor siren is registered on the base unit, the alarm can only be stopped by the remote control unit after 15 seconds at the earliest.

Press the  button.

Alarm Mode

You should activate Alarm mode when you leave your apartment or house. Before doing so, check that all the doors and windows provided with a door/window contact are closed.

Press the  button.

At Home Mode

During the night, when you are asleep, you should activate At Home mode. Before doing so, check that all the doors and windows are closed.

Press the  button.

Silent Mode

When you leave your apartment or house, you can activate Silent mode instead of Alarm mode. Before doing so, check that all the doors and windows are closed.

Press the  and  buttons simultaneously.

Disarmed Mode

When the system is disarmed, you can move freely within the living quarters without triggering any alarms.

Press the  button.

Changing the Battery

1. Use a precision screwdriver to loosen the screw in the battery compartment on the underside of the remote control.
2. Remove the battery compartment cover.
3. Remove the battery contained.
4. Insert a new CR2430 3 V lithium battery in the battery compartment (ensure correct polarity).
5. Replace the cover on the battery compartment.
6. Replace and tighten the screw.

Technical Data

Weight:	24 g
Dimensions (W x H x D):	40 x 60 x 14.5 mm
Frequency:	868.5 MHz
Battery	1 x lithium CR2430 3 V

SOS Remote Control

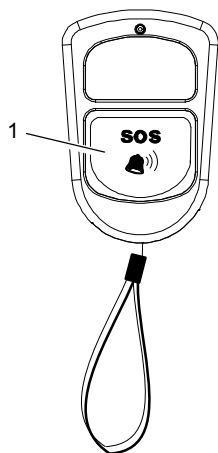

Fig. 1

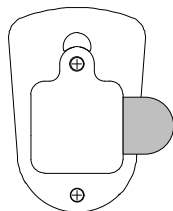

Fig. 2

Intended Use

The SOS remote control enables people who are old or living alone to issue an SOS alarm in the case of an emergency. When activated, the SOS remote control sends a radio signal which can be received by alarm systems from the Protect series.

A condition for complying with the intended use is that the equipment is installed correctly and the information in this instruction manual is observed and maintained.

Any other use is considered unintended use. Unauthorised modifications or reconstructions not described in this instruction manual are not permitted and could cause the product to be damaged. Furthermore, risks through short-circuits, fire, electric shock etc. cannot be ruled out.

i The SOS remote control only works in combination with an alarm system from the Protect series!

Important Safety Information

⚠ WARNING!

- **Risk of suffocation!**

Children could swallow small parts, packing material or protective foil.

➡ **Keep the product and packaging out of reach of children!**

Notes on Use

The emergency button module can be carried in a pocket or hung around the neck so it is permanently close by. If the person should fall somewhere in their residence, for example, a simple press on the SOS button on the SOS remote control

module (Fig. 1-1) transmits an alarm signal to the base unit of the respective Protect alarm system.

Scope of Delivery

SOS remote control	1
Battery	1 x lithium CR2430 3 V
Neckband	1
Instruction manual	1

Please check the contents of the package carefully. If anything is missing or has been damaged during transport, DO NOT put the SOS remote control into operation!

Starting Up

The SOS remote control is supplied with a battery already inserted. To put the SOS remote control into operation, remove the plastic strips (Fig. 2) from the battery on the rear side.

Registering the SOS Remote Control on the Alarm System

The SOS remote control must be registered on an alarm system from the Protect series.

1. Select the **Register** menu option on the alarm system.
2. Press the SOS button (Fig. 1-1) on the SOS remote control.
3. When the message **Remote:** followed by a number appears in the alarm system display, registration on the alarm system was successful.
4. Change the entry in the alarm system as necessary.

-  To configure the alarm system, please refer to the manual related to the alarm system.

Changing the Battery

1. Use a precision screwdriver to loosen the screw in the battery compartment on the underside of the SOS remote control.
2. Remove the battery compartment cover.
3. Remove the battery contained.
4. Insert a new CR2430 3 V lithium battery in the battery compartment (ensure correct polarity!).
5. Replace the cover on the battery compartment.
6. Replace and tighten the screw.

Technical Data

Weight:	28 g
Dimensions (W x H x D):	40 x 59 x 15 mm
Frequency:	868.5 MHz
Battery:	1 x lithium CR2430 3 V

Convenient Remote Control

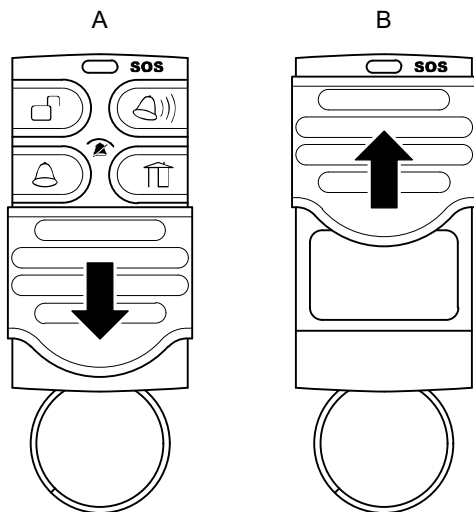

Fig. 1

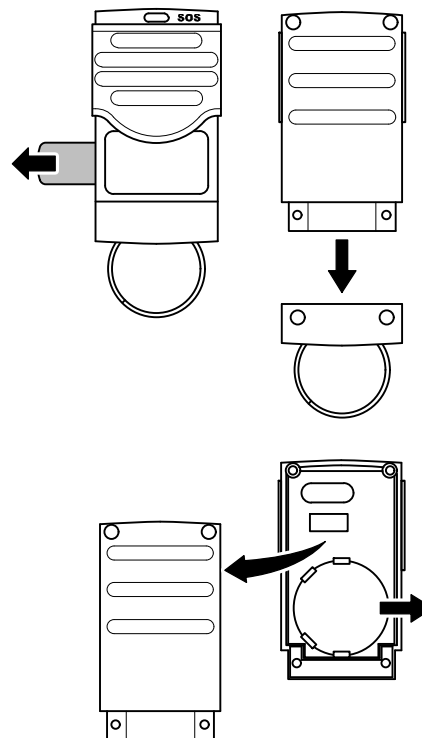



Fig. 2

Intended Use

The remote control serves for the remote control of an alarm system from the Protect series.

A condition for complying with the intended use is that the equipment is installed correctly and the information in this instruction manual is observed and maintained.

Any other use is considered unintended use. Unauthorised modifications or reconstructions not described in this instruction manual are not permitted and could cause the product to be damaged. Furthermore, risks through short-circuits, fire, electric shock etc. cannot be ruled out.

 The remote control only works in combination with an alarm system from the Protect series!

Important Safety Information

WARNING!

- **Risk of suffocation!**
Children could swallow small parts, packing materials or protective foil.
- ➔ **Keep the product and packaging out of reach of children!**

Scope of Delivery





Remote control	1
Battery	1 x lithium CR2032 3 V
Instruction manual	1

Please check the contents of the package carefully. If anything is missing or has been damaged during transport, DO NOT put the remote control into operation!

Starting Up

The remote control is supplied with a battery already inserted. To put the remote control into operation, remove the plastic strips (FIG. 2) from the battery on the rear side.

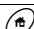
Operating Elements

Key	Function
	Emergency call (SOS) or panic function (can be optionally configured on the base unit)
	Alarm mode: On burglary, acoustic alarm signal issued and internal telephone dialling unit activated
	At Home mode: On burglary, acoustic alarm is issued
	Disable base unit key lock function, Stop the alarm signal, Disarm the alarm system.
	Silent mode on pressing the Alarm and At Home mode buttons simultaneously

Registering the Remote Control on the Alarm System

The remote control must be registered on an alarm system from the Protect series.

1. Select the **Register** menu option on the alarm system.
2. Press the SOS button  on the remote control.
3. When the message **Remote:** followed by a number appears in the alarm system display, registration on the alarm system was successful.
4. Change the entry in the alarm system as necessary.

 To configure the alarm system, please refer to the manual related to the alarm system.

Configuring the SOS Button

The  button on the remote control can be configured as an Emergency Call or Panic button via the Protect alarm system base unit.

 To configure the alarm system, please refer to the manual related to the alarm system.

Stopping the Alarm

 If an outdoor siren is registered on the base unit, the alarm can only be stopped by the remote control unit after 15 seconds at the earliest.

Press the  button.

Alarm Mode

You should activate Alarm mode when you leave your apartment or house. Before doing so, check that all the doors and windows provided with a door/window contact are closed.

Press the  button.



At Home Mode

During the night, when you are asleep, you should activate At Home mode. Before doing so, check that all the doors and windows are closed.

Press the  button.

Silent Mode

When you leave your apartment or house, you can activate Silent mode instead of Alarm mode. Before doing so, check that all the doors and windows are closed.

Press the  and  buttons simultaneously.

Disarmed Mode

When the system is disarmed, you can move freely within the living quarters without triggering any alarms.

Press the  button.

Changing the Battery

1. Use a precision screwdriver to loosen the screw in the battery compartment on the underside of the remote control (Fig. 2).
2. Remove the battery compartment cover.
3. Remove the battery contained.
4. Insert a new CR2032 3 V lithium battery in the battery compartment (ensure correct polarity).
5. Replace the cover on the battery compartment.
6. Replace and tighten the screw.

Technical Data

Weight:	16 g
Dimensions (W x H x D):	30 x 58,5 x 13.7 mm
Frequency:	868.5 MHz
Battery	1 x lithium CR2032 3 V

Outdoor Siren

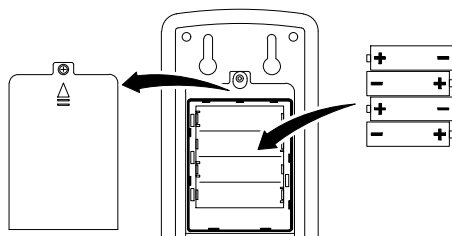

Fig. 1

Intended Use

The outdoor siren has been designed for use in combination with an alarm system from the Protect series and, when triggered, it not only provides a visual signal but also a loud, acoustic signal.

A condition for complying with the intended use is that the equipment is installed correctly and the information in this instruction manual is observed and maintained.

Any other use is considered unintended use. Unauthorised modifications or reconstructions not described in this instruction manual are not permitted and could cause the product to be damaged. Furthermore, risks through short-circuits, fire, electric shock etc. cannot be ruled out.

i The outdoor siren only works in combination with an alarm system from the Protect series!

Important Safety Information

⚠ WARNING:

- Risk of suffocation!

Children could swallow small parts, packing materials or protective foil.

➔ Keep the product and packaging out of reach of children!

⚠ CAUTION!

- Hearing damage through loud alarm signal!

The alarm signal is loud and could cause hearing damage.

➔ Only use the product in the recommended installation locations.

➔ Do not hold the product near your ears to test it.

➔ Do not remain in the vicinity of the acoustic alarm for a longer period when it has been triggered.

i The outdoor siren only works with properly charged, correctly installed batteries. The outdoor siren must not be operated using rechargeable batteries.

i Due to legal requirements, the alarm signal continues for maximally 120 seconds. The alarm signal switches off automatically after approx. 120 seconds if the user does not interrupt it.

Scope of Delivery

Outdoor siren	1
Batteries	4 x AAA batteries

Assembly material	Screws, dowels
Instruction manual	1

Please check the contents of the package carefully. If anything is missing or has been damaged during transport, DO NOT put the outdoor siren into operation!

Installation

Installation Steps

**WARNING!**

- Risk of serious injuries through damaging cables or lines!
- ➡ During installation, pay attention to the possibility of cables running in the walls. We are not deemed liable for installation errors. If in doubt, contact a specialist!

Proceed as follows to assemble the outdoor siren:

1. Ensure that there are no electric cables, gas or water pipes near the installation location.
2. Drill two holes, approx. 37 mm apart, at the intended installation location and insert the screws supplied using dowels. The screw heads must project about 3 mm from the wall so that the outdoor siren can be hooked on them.
3. Loosen the screw in the battery compartment cover using a screwdriver and insert the batteries supplied in the outdoor siren, paying attention to correct polarity (Fig. 1).
4. Register the outdoor siren on the base unit of the alarm system (refer to Registering the Outdoor Siren on the Alarm System).
5. Slide the battery compartment cover on the outdoor siren and tighten the screw in the battery compartment cover tight.

6. Hook the slots in the rear panel of the outdoor siren on the screws installed in the wall in Step 2.

Registering the Outdoor Siren on the Alarm System

The outdoor siren must be registered on an alarm system from the Protect series.

1. Select the **Register** menu option on the alarm system.
2. Remove the batteries from the outdoor siren's battery compartment.
3. Replace the batteries in the outdoor siren. As soon as the last battery is inserted in the outdoor siren, you will hear a short acoustic signal indicating registration on the base unit.
4. When the message **Speaker** followed by a number appears in the alarm system display, registration on the alarm system was successful.
5. If the outdoor siren has not been registered successfully, remove one of the batteries and then replace it.
6. Change the entry in the alarm system as necessary.

 To configure the alarm system, please refer to the manual related to the alarm system.

Technical Data

Weight:	198 g
Dimensions (W x H x D):	92 x 138 x 49 mm
Frequency:	868 MHz
Batteries	4 x AAA batteries

GSM Antenna

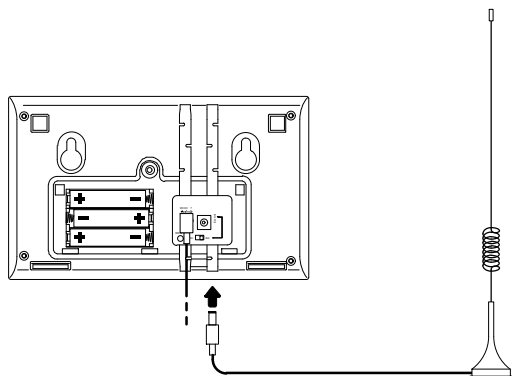

Fig. 1

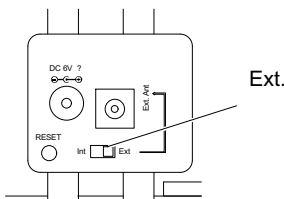

Fig. 2

Intended Use

The GSM antenna is designed for use together with an alarm system from the Protect series. The GSM antenna serves to improve the mobile communication connection if the signal received from the mobile network is weak. The GSM antenna does not strengthen the connection to the sensors.

A condition for complying with the intended use is that the equipment is installed correctly and the information in this instruction manual is observed and maintained.

Any other use is considered unintended use. Unauthorised modifications or reconstructions not described in this instruction manual are not permitted and could cause the product to be damaged. Furthermore, risks through short-circuits, fire, electric shock etc. cannot be ruled out.

Important Safety Information

 **WARNING!**

- Risk of suffocation!
Children could swallow small parts, packing materials or protective foil.
- ➔ Keep the product and packaging out of reach of children!

Scope of Delivery

GSM antenna and cable	1
Instruction manual	1

Please check the contents of the package carefully. If anything is missing or has been damaged during transport, DO NOT put the GSM antenna into operation!

Installation

Installation Steps

Proceed as follows to assemble the GSM antenna:

1. Use a screwdriver to loosen the screw in the battery and connection socket compartment on the underside of the base unit of the Protect 9XXX series alarm system.
2. Remove the lid from the battery and connection socket compartment.
3. Insert the plug on the GSM antenna in the socket provided. Refer to Fig. 2.
4. Set the antenna switch to **Ext.** Refer to Fig. 3.
5. Replace the lid on the battery and connection socket compartment.
6. Tighten the screws using a screwdriver.

Technical Data

Weight:	48 g
Dimensions (height):	290 mm
Cable length:	Approx. 3 m